

# Wabo® FastWrapWC

Wall and Ceiling Expansion Joint Systems

Features	Benefits
<ul style="list-style-type: none"> <li>• Durable and time tested</li> </ul>	Limited maintenance
<ul style="list-style-type: none"> <li>• Narrow sight lines</li> </ul>	Aesthetically attractive
<ul style="list-style-type: none"> <li>• Fast simple installation</li> </ul>	Reduces installation time and labor costs
<ul style="list-style-type: none"> <li>• Standard flush or optional serrated seal profiles available</li> </ul>	Versatility in product options to accommodate design and building movement



## DESCRIPTION:

Wabo® FastWrapWC Series is a proven joint system with narrow sightlines that offers a choice of models, each of which consists of a variety of elastomeric seals and edge retainers. This variety provides a wide range of attachment solutions for wall and ceiling applications and permits selection of a system appropriate for the expected movement and project conditions including compliance with ADA guidelines.

The standard flat surface elastomeric seals provide a flush installation and are available in standard black, beige, gray & *ColorChoice* colors. The optional serrated surface seal is available in the same colors and offers enhanced movement capabilities.

## RECOMMENDED FOR:

- All Interior wall, ceiling, and soffit expansion joint applications.
- For use in various construction projects including:
  - Health-Care
  - Transportation
  - Recreation
  - Retail
  - Commercial
  - Educational
  - Parking Garage (interior areas)

## PACKAGING/COVERAGE:

- Aluminum Profiles: bundled in standard 10-foot lengths.
- Elastomeric Seals: Shipped in longest practical continuous length.
- Accessories: In manufacturer's standard labeled carton.

**TECHNICAL DATA:**

**Design Information:**

WaboFastWrap WC is available in five different models. Models CES and CEB have been designed to accommodate typical ceiling applications. Models CWS, CWF, and CWC have been designed to accommodate typical wall applications. These models also have an optional serrated elastomeric seal for enhanced movement

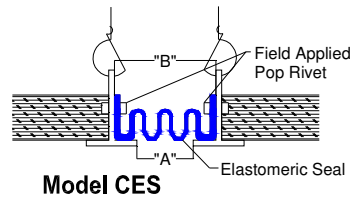
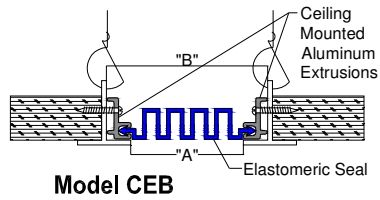

Optional Serrated Elastomeric Seal (for Models CWS, CWF, and CWC)

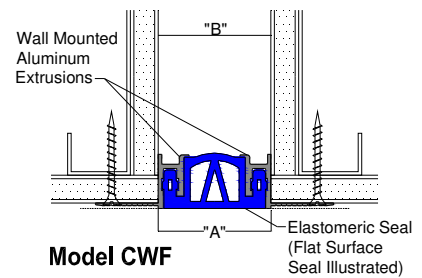
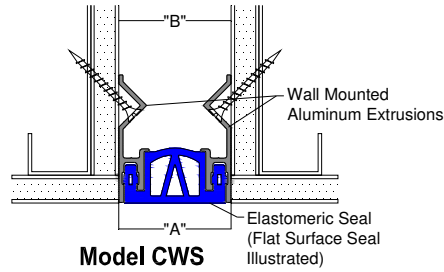
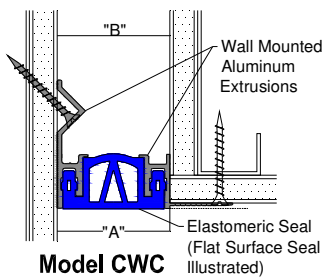

**Movement Table**

Model Number	JT. Opening "A"		System Width "B"		Total Movement	
	inches	mm	inches	mm	inches	mm
CEB-100	1.0	25	1.88	48	1.00	25
CEB-150	1.5	38	2.38	60	1.00	25
CEB-200	2.0	51	2.88	73	3.50	89
CEB-300	3.0	76	3.88	98	3.50	89
CEB-400	4.0	102	4.88	124	4.00	102
CES-100	1.0	25	2.00	51	1.00	25
CES-200	2.0	51	3.00	76	2.00	51
CWC-200	2.0	51	2.00	51	0.75	19
CWC-300	3.0	76	3.00	76	1.50	38
CWS-200	2.0	51	2.00	51	0.75	19
CWS-300	3.0	76	3.00	76	1.50	38
CWF-200	2.0	51	2.00	51	0.75	19
CWF-300	3.0	76	3.00	76	1.50	38

Note: see sales drawings for additional details



## PHYSICAL PROPERTIES:

**Extrusions:** Material shall conform to properties of ASTM B221, 6063-T5 aluminum alloy. Supplied in standard mill finish.

**Elastomeric Seals** - Material shall be a flexible extruded polyvinyl chloride or manufacturer's alternate material exhibiting a shore A hardness of 64 +/-5 with U.V. stabilizer. Standard colors: black, beige, gray except models CES and CEB. Models CES and CEB standard color is white.

**Moisture Barrier (optional):** Provide fabric reinforced clear vinyl sheet material .026" (min.) thickness

**Anchorage:** Style and spacing varies according to system. All anchors for suspended ceiling or drywall applications will be supplied by installing contractor. For masonry or concrete applications manufacturer shall provide 1/4" dia. x 1 3/4" lg. (min.) hex head threaded concrete anchor.

**Concrete Slab Repair:** (recommended). Provide Wabo® Renew 100 rapid strength repair mortar.

**Blockout Infill Material:** (recommended). Provide Wabo® Grout 100 rapid strength repair mortar.

## APPLICATION:

### Installation Summary:

- Protect all expansion joint components from damage during installation and protect finished installation from damage from other trades during all work activities.
- Expansion joint systems shall be installed in accordance with manufacturer's typical details and installation procedures.
- Wall or ceiling construction and materials shall be designed to allow for proper installation of system and its components. Construct any wall recess in accordance with manufacturer's recommendations.
- Construct joint openings consistent in width and straight along joint height. Utilize double metal studs on both sides of the joint opening. Inspect and verify all substrates to be solid and sound prior to work.
- Construct all adjacent walls to be vertically flat along height and flush across both sides of the opening. Inspect and verify all substrates to be solid and sound prior to work.
- Install required gypsum wallboard inside joint opening at fire rated locations. Install appropriate fire barrier system, if required by building code and rated construction. Contact WBA for recommendations on appropriate fire barrier system.
- Metal components shall be cut to length on job site where required. Components shall be miter cut in the field to conform to directional changes unless otherwise contracted with expansion joint manufacturer.
- All anchor holes shall be field drilled in accordance with manufacture's drawings.

### For Best Results:

- Do not install if the joint's anticipated movement will exceed the system's movement range.
- Deliver product in each manufacturer's original, intact, labeled containers. Protect the work area with appropriate plastic sheeting.
- Do not allow any of the components to freeze prior to installation. Store all components out of direct sunlight in a clean, dry location between 50°F (10°C) and 90°F (32°C). Store off the ground and protect from weather and construction activities.
- Do not use for external locations, which require watertight expansion joint system. Contact WBA for recommendations.
- Periodically inspect the installed material and repair localized areas as needed. Inspect for loose components and/or hardware, repair as necessary. Consult a Watson Bowman Acme representative for additional information.
- Make certain the most current version of the product data sheet is being used. Please consult the website ([www.wbacorp.com](http://www.wbacorp.com)) or contact a customer service representative.
- Proper application is the responsibility of the user. Field visits by Watson Bowman Acme personnel are for the purpose of making technical recommendations only and not for supervising or providing quality control on the jobsite.

### Related Documents:

- Material Safety Data Sheets
- WaboFastWrap Specification
- WaboFastWrap Sales Drawings
- WaboFastWrap Installation Procedure



**LIMITED WARRANTY:**

Watson Bowman Acme Corp. warrants that this product conforms to its current applicable specifications. WATSON BOWMAN ACME CORP. MAKES NO OTHER WARRANTY, EXPRESS OR IMPLIED, INCLUDING ANY WARRANTY OF MERCHANTABILITY OR WARRANTY OF FITNESS FOR A PARTICULAR PURPOSE. The sole and exclusive remedy of Purchaser for any claim concerning this product, including, but not limited to, claims alleging breach of warranty, negligence, strict liability or otherwise, is the replacement of product or refund of the purchase price, at the sole option of Watson Bowman Acme Corp. Any claims concerning this product shall be submitted in writing within one year of the delivery date of this product to Purchaser and any claims not presented within that period are waived by Purchaser. IN NO EVENT SHALL WATSON BOWMAN ACME CORP. BE LIABLE FOR ANY SPECIAL, INCIDENTAL, CONSEQUENTIAL (INCLUDES LOSS OF PROFITS) OR PUNITIVE DAMAGES. Other warranties may be available when the product is installed by a factory trained installer. Contact your local Watson Bowman Acme representative for details. The data expressed herein is true and accurate to the best of our knowledge at the time published; it is, however, subject to change without notice.

**Contact**

*Watson Bowman Acme Corp. 95 Pineview Drive, Amherst, NY 14228  
phone: 716-691-7566 / fax: 716-691-9239 / web site: <http://www.wbacorp.com>*

**WaboFastWrapWC\_1206**