

# TOTALFLASH™

CAVITY-WALL DRAINAGE SYSTEM  
by Mortar Net USA, Ltd.

**Special Sizes for Restoration  
or Remediation Jobs, Too!**

**1 Pre-Formed  
CORNER BOOTS,  
STAINLESS STEEL CORNERS  
& END DAMS**  
for "perfect" corners every time.

**2 Built-In  
NO-CLOG  
DRAINAGE MATTE**  
lets water pass,  
unobstructed,  
to Weep Tabs.

**3 Built-In  
TERMINATION BARS**  
with pre-drilled holes,  
allow quick, one-man  
installation.

**4 5-1/2 ft. Panels of  
PRE-CUT FLEXIBLE FLASHING\***  
All main components are  
**factory-assembled** onto  
easy-to-mount  
flashing panels.

**8 Built-In  
NO-CLOG  
WEEP TABS**  
deliver moisture  
to the outside  
of the building.

**7 Built-In  
STAINLESS STEEL  
DRIP EDGE**  
releases moisture  
away from building.

**6 Clearly Specified  
LAP JOINTS**  
enforce complete  
secure coverage.

**5 Built-In  
EDGE DAM**  
directs  
moisture  
out of  
building.

**SCREWS & ADHESIVES  
INCLUDED**

in each box of  
TOTALFLASH™

*\*Our Standard Flashing Membrane is an 18-inch, 40-mil polymeric, reinforced, UV stable membrane, incorporating DuPont's Elvaloy® KEE polymer.*

**IT'S 100 YEARS OF MOISTURE-CONTROL TECHNOLOGY  
THAT YOU CAN HOLD WITH ONE HAND.**

Wondering how anyone could give you twice your usual protection (or more), with half your usual time & labor (or less)? Just see what our masonry experts have managed to build into each handy, 5-1/2-foot panel of premium flashing.

With  
**TOTALFlash™ -  
Everyone Wins!**

Flashing alone isn't enough to meet today's rigorous moisture-control demands. But until now, higher protection meant higher expenses for time & labor.

**TOTALFlash™** changed all that, delivering higher protection with lower costs. But the benefits don't end there:

**BUILDERS** see quicker completion while lowering the risk of future wall-damage or mold-growth.

**MASONS** no longer have to order an array of components, then hope everything arrives on time.

- They no longer have to struggle with "field-cutting" awkward flashing-rolls.

- Our new Pre-Formed Corners get them off to a quicker start.

- **TOTALFlash™** high-speed installation lets them start laying brick much sooner.

**ARCHITECTS** get the coverage they specified. (Our clearly marked Lap Joints make it virtually foolproof!)

**OWNERS** enjoys greater peace-of-mind and a longer building-life.

**TENANTS** breathe easier, knowing there's far less chance of moisture-related illness.

What will

**Mortar Net®**  
think of next? USA LTD.

800-664-6638 MortarNet.com

**TOTALFLASH™**  
 CAVITY-WALL DRAINAGE SYSTEM  
 by Mortar Net USA, Ltd.

**NOTHING to Cut**

The job starts with corners, but you don't have to make them by hand any more. Our flawless, factory-built CornerBoots save you time & trouble.

And of course our new TOTALFlash™ means masons can quit being roofers, because each panel comes pre-cut to a handy, 5-foot length. (See inside.)

**NOTHING Faster**

TOTALFlash™ can be installed by one worker, at speeds twice as fast as anything else they've used. Half the labor, half the time--it adds up to nice savings all around.

**NOTHING Protects Better**

For example, even when mortar or grout droppings pile up to the top of the dovetails, water will still escape through TOTALFlash™ layer of no-clog polyester mesh.

The Beauty of **Green**

Ideally, masonry buildings should last for centuries. Such longevity isn't just a benefit to the building's owner, it's a plus for our whole environment. Demolition wastes the resources that went into the old building, then spends new resources to build its replacement.

TOTALFlash™ guards against the damage trapped moisture can cause to a building's exterior masonry walls, thus helping to prevent costly waste. It also works to suppress the air-quality hazards that can arise in damp wall cavities.

**SECOND Chances**

It happens that TOTALFlash™ was invented by Tom Sourlis, who restored the masonry of Chicago's famed Water Tower and many other historic landmarks.

Tom made sure to create TOTALFlash™ in sizes that could be easily installed in existing structures, while removing only the normal number of courses.

TOTALFlash™ can give older buildings a new lease on life, while helping to sustain our nation's resources.



The use of TOTALFLASH™ may help your project qualify for LEED credits.



2009 US Green Building Council Sweets.com

ARCAT



**NEW**

**TOTALFLASH™**  
 CAVITY-WALL DRAINAGE SYSTEM  
 by Mortar Net USA, Ltd.

THE FIRST MASONRY FLASHING SYSTEM...

**That Has It All!**

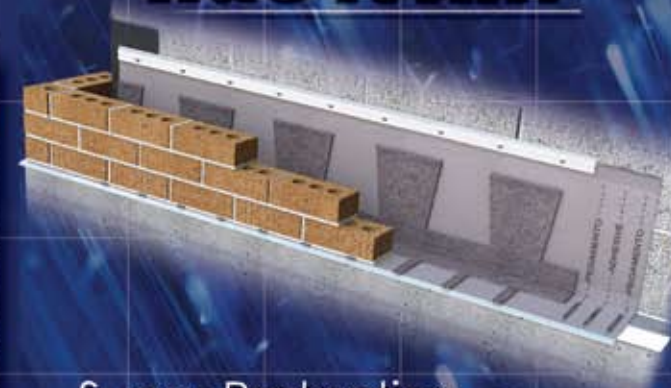

Super Protection.  
 Super-Quick Installation.  
 Super Savings.

**Mortar Net®**  
 USA LTD.

800-664-6638  
 MortarNet.com

**TOTAL Protection That Installs In A FLASH**

What will

**Mortar Net®**  
 think of next?